

UPCOMING EVENTS

- 2 - 4H Class begins
- 3 - Fun Match
- 9 - Teacher Training
- 14, 15 - Agility Trial
- 16 - New Classes Begin

Rally and Obedience Trial
November 3-5

BARKS



Pusheen



ELSA AND FRIEND

Note from the President's Article Bag

Another month has gone by- can you believe it?!

It's been another great month at GABOC. Happy students and dogs that are learning a lot. I hear from our Registrar Pat that we are full up for the round of classes. How amazing is that?

Help wanted:

It would be a big help if there was someone who would like to take over or assist with matches. With a change in my job, having assistance here to organize judges, stewards, and publicity would be huge. This job is getting done but somewhat last minute and if we had assistance distributing flyers, etc., it would be great.

Pat Senne has created sign up sheets for the November trial. We will have these available at training night for sign up. We feel we will have a strong attendance considering the excellent support that the obedience community gives the Francis Field Dog Obedience School. New members, stewarding is the best way to learn how to show your dogs- watching other handlers really gives you direction and working with the judges helps you understand the process. For those of you we have not seen for a while, we'd sure love to see you again. Remember, stewarding at the matches and trials earns you credits towards awards.

November 2nd- Rally Match

November 3rd – Double Rally Trial and OB Match in the evening

November 4th and 5th OB and Rally trials

We need a committed person for Rally on Tuesdays to revitalize our attendance. Tuesday's can be crazy busy with ring rentals and rally and a full ring for conformation. Please contact our new DOT Pattie Imburgia.

October 3 is our next correction match. Tell your friends! Helpers are always welcome, let me know if you are interested!

Show season is upon us with all the neighboring clubs holding their trials. Ours, Fox Valley, Car dun AI, and Stone City. Practice, practice, practice! Hope to see you there!

Joan and My Team

Esmonds Bel Air Rides Like the Wind PUDX, RE CGC, MRC & GABOC HOF

Mondenkind's Majestic Phaze UD, RE, TKN, CGC, GABOC HOF



Howl-O-Ween Safety

HALLOWEEN PET SAFETY TIPS



Trick or treaters can scare your pets. Keep pets safe and secure, ideally in a room away from the commotion at the door.

Halloween is the 2nd most common holiday for pets to be lost. Make sure all ID tags are up to date.



Candy can make your dog sick! If your dog eats chocolate or xylitol containing candy, call your vet or the ASPCA poison control (888-426-4435) immediately- it's toxic to dogs!



Lit pumpkins and wires can cause fires! Keep your pets away from wires, fires, and cords.



Pick safe pet costumes that don't affect your pet's breathing, seeing, or hearing.



HAVE A SCARY GOOD TIME!



cuteness.com

Halloween is right around the corner! Keep your pet safe and happy with these tips from cuteness.com.

Have a safe and spooky Howl-O-Ween!



DuPage County Animal Care and Control

dupageco.org/AnimalControl

@DuPageCACC





Windy's Mom Says

Train don't complain- quite the mantra but it is true. As me and Windy enter this next show season, some things I know she will do and just know it, good and bad. Some things like taking steps forward on command discrimination and signals, always a habit and something we work on but we are refocused on fixing this all the more even though she is 7 and has done so much. You can teach your "old dog" a new trick. We are simply polishing this up and rewarding the good, not allowing those little steps that build up. Positive reinforcement as fast as possible for when she really nails it and gets it right. Where can you find this in your performance? That little thing that costs you a few points that you can get back? Think about this the next time you practice and take those few extra moments to add that polish to your performance!

Joan and Windy



Windy and Mars have a new family member, Rose the kitten who Carol Schmidt fostered and offered for adoption! Windy is an awesome big sister to this tiny baby!



We had the pleasure of watching Ed Gegenheimer and his beautiful Doberman earn their first UD leg with a second place at the Car Dun AI show! It was awesome!



“Are dog parks good or bad?”

It's a question I hear from concerned pet parents all the time.

And I don't blame them for asking, Kathryn —

Because the truth is, there's so much conflicting information out there...

And there's one thing most of that information isn't factoring in:

Your unique dog.

After all, no two dogs are the same — so what's good for YOUR dog might not be good for another...

So how can YOU decide if a dog park is right for your pup?

Let's weigh the **pros** & **cons**:

✅ Pro #1: Village Green

Like us, dogs are social creatures...

So you might think of the dog park as your pup's town square, village green or local watering hole.

It's a place where they can meet other four-legged friends, learn how to get along with other breeds, sizes, ages, and temperaments...

And hopefully make lifelong friends — which can help improve their emotional well-being and overall quality of life.

❌ Con #1: Bad Behavior Magnet

Also like us, dogs mimic behavior...

So depending on the dogs that are at the park that day, your pup could come away with some pretty bad habits...

Including rough play, excessive barking or humping, or ignoring your commands.

Thank you Kathy B

✓ Pro #2: Bonding Opportunity

Your dog loves being with you — and the dog park can be a new, fun place for you to spend some quality time together.

The exciting location can be a stimulating change of pace for your pup, especially if they spend a lot of time indoors...

✗ Con #2: Fight Club

Unfortunately, fights at the dog park are all too common.

Your dog could be knocked down in a scuffle, or in a worst-case scenario, even attacked by an aggressive dog.

So if you do visit a dog park, be sure to remain vigilant at all times to protect your pup.

✓ Pro #3: Run it Out

Exercise is *crucial* to canine health...

And the dog park is a perfect place to get it!

In fact, just an hour at the park can provide your pup with a full day's worth of exercise...

✗ Con #3: Danger Zone

You may already know that the dog park isn't the cleanest place in the world...

But some are so dirty, they can actually make your pup *sick*.

An unmaintained park (with dirty puddles, piles of poop, and garbage) can be a *breeding ground for bacteria*...

And since illnesses can easily be passed from dog to dog...

Your dog could come away with a common canine infection or parasite, like giardia, kennel cough, coccidia, parvovirus, and worms.

Before taking your dog to the dog park, check out the park on your own first.

Some parks are better than others — and you'll want to make sure you're bringing your pup to a **safe, clean** spot.

Make sure the grass or ground is well-maintained and free of sharp rocks, glass, and debris...

And that the park has clean water bowls, trash bins, and disposal areas for dog waste.

Also, do your homework to find a park that requires dogs to be **vaccinated** and **trained**...

That way, you can mitigate the risk of your pup getting sick or picking up bad habits.

At the park:

Remain vigilant at all times.

Keep a close eye on your dog and the dogs they interact with.

It's normal for pups to play or wrestle, but if another dog bares their teeth or snaps at your dog, that's probably a sign they don't want to play.

Remove your dog from the situation immediately by calling them over — and if the aggressive behavior continues, leave the park.

(If your dog is bitten by another dog — get their parent's phone number. Your vet will want to know if they've been vaccinated for rabies and other viruses.)

Mind the heat — On hot days, try to visit the park in the morning or late afternoon when the weather is cooler.

Make sure there's a clean water bowl available at the park (or bring your own) and encourage your pup to drink from it frequently.

Respect the park — pick up your dog's poop and encourage your fellow dog parents to do the same.

Lastly, listen to your gut — if something feels wrong, leash up your pup and head out of the park.

Post-park:

Once you're home, scan your pup for fleas, ticks, and injuries.

Run a fine-toothed comb through your dog's fur, starting from the head and working your way down to the tail...

And then rub your hands over your dog's body, feeling for any lumps, bumps, or signs of redness or swelling.

Pay attention to any areas that your dog reacts to or seem sensitive.

Tip: Make sure to check behind their ears and between their toes.

Reward them with a treat and plenty of water, rest and relaxation for the remainder of the day — they earned it!

I hope these tips helped, Kathryn.

Remember, you're the best judge of whether the dog park is right for your unique pup...

So I hope this email empowers you to make a choice you feel good about.

To happy and healthy dog years ahead,
Dr. Gary Richter

Dr. Richter's Dog Park Dos & Don'ts:

Do remain vigilant at all times – even if your dog is off-leash, they should always remain supervised.

Don't bring unvaccinated dogs to the park.

Remember, your pup isn't protected until a few weeks after their final dose of a vaccine, so wait until then.

Do keep the park clean by picking up your dog's poop and encouraging others to do the same.

Don't bring toys or treats to the park

– they could invite possessive, aggressive behavior.

(If you must bring a toy, opt for a tennis ball – just be prepared, you might leave without it 😊)

Protect against ticks before/after attending the dog park with a preventative medicine (like an ointment or a pill) and a good screening afterwards.

Don't bring an aggressive or sick dog to the park.

They could be a hazard to other pups and people.

Do know the rules – make sure your dog is fixed, vaccinated, and/or registered **BEFORE** entering the dog park (every park has different rules).



IT'S RENEWAL TIME AGAIN!!!

Please fill out the membership renewal form below and send it with your check to:

Karen Schlipf
26W115 Blackhawk Drive
Wheaton, IL 60189

Renewal form MUST be received by December 31, 2023

20.00 Single \$25.00 Family

NOTE: Donations to offset the cost for the Obedience and Agility Trials would be most appreciated.

Please make check out to GABOC

Membership Dues:	\$ _____
Donation to help offset the Agility Trial cost	\$ _____
Donation to help offset the Obedience Trial cost	\$ _____
TOTAL Enclosed	\$ _____

GABOC MEMBERSHIP RENEWAL FORM

PLEASE PRINT LEGIBLY!!

NAME: _____

ADDRESS: _____ CITY/STATE/ZIP _____

PHONE: _____ EMAIL: _____

DOG(S) NAMES(S): _____

Print Names of Dogs? Yes No Print Breed of Dogs? Yes No

Instructor Board Member Trial Committee DOT Registrar Other

Comments, questions, suggestions? _____

NOTE: I agree to grant to this club permission to photograph and/or video, pictures of my participation. I further agree that any of the recordings may be used in club publications, or on social media to promote GABOC, and further that such use shall be without payment of fees, royalties, special credit or other compensation.

Brag for Barks

Mars earned his first UDX leg on August 26 at the Car Dun Al show, one down nine to go! Good Fluffy Boy!



Glenbard membership meeting September 13, 2023
At Fairgrounds, **outside** by building 5

Meeting called to order 7:10 PM

Members in attendance: Pat Senne, Mary Schuenemann, Mary Ramsden, Pattie Imburgia, Laura Woll, Karen Schlipf, Xelines Barreto, Gina Hoener, Sandi Stephenson, Tom Stephenson, Ed Gegenheimer, Heather Shedd, Kelsey Romanowski, Joan Mazat, and Carole Moen, Shawn and John Henry arrived around 7:45 PM. Mary Therese Marosits arrived 7:56 PM.

Joan brought up not having Zoom at the meetings because she cannot monitor it and run the meeting. If someone would like to do that we could bring back Zoom for the meetings. Xelines offered to do it.

Joan stated at our September match we did not have many preregistered people, but then a lot of Novice A people showed up.

Vice Presidents report: Karen had three applications for membership.

Heather Shedd with Lux and Nox - Dutch Shepherds

Mary Schuenemann with Bookin' - Golden

Kelsey Romanowski with Novo and Bree - Belgian Shepherds

All were voted into membership.

Karen stated we have 73 members and 21 lifetime members.

Joan passed out the treasures report. Shawn was pleased that we are in the black.

June minutes taken by Pat S and sent out in Constant Contact were approved. Motion by Sandi and seconded by Mary.

Sandi wanted to thank Dean for making the rings bigger.

We still have not ordered ring gates and extensions.

Pat mentioned that Lyons had some accordion ring barriers that they wanted to dispose of. She would follow up on that and see what the cost might be.

Karen said she had some mats that she would give up.

Registrar report: Pat said at this time we are not going to do a therapy dog class.

She suggested we might consider an Advanced CGC class if we can find someone to teach it.

That might entice some people to continue on with their dogs.

4H: Sandi and Pat judged at IL State 4H show at Granny Rose K9 Enrichment Center in Dixon.

The kids did a good job.

One of the girls in Laura Setar's and Tom's 4H class got second place in Best of the Best

There was some discussion about getting her some sort of award for \$25 or less. Pat will follow up with Laura on it.

Rally needs an instructor. Setting up the ring is not enough. Pat said she could oversee it if we moved Rally to Monday. Pat is at Lyons on Tuesday. Xelines said she could assist Pat.

On October 17th Sheila will not be able to do her conformation class. There was some discussion about finding a substitute for that evening. Carole mentioned several years ago we had a guest conformation person come in to teach one night.

We will look for someone to cover Sheila's class.

DOT: Pattie needs to know her duties as DOT.

She wanted to know how the new instructors were working out.

Sandi felt one of the most important duties of the DOT was to have a list of substitute instructors.

Francis was suggested as a substitute.

Ed said he needs Pattie's cell number in case he would have to contact her if he could not make his class.

Karen said the DOT should have a key for the building.

Membership: Ed said it takes too long to be approved for membership. Is there some way it could be streamlined to do quicker? Waiting for bimonthly meetings takes too long. Would this be a By Law amendment?

Our **By Laws** need to be updated. Carole said it needs to be put in a Word doc. Gina felt she could do that. Gina, Ed, Sandi, Pat and Carole offered to work on it.

Classes: Gina felt we should raise our class prices. She said we were one of the cheapest. She had compared ours to For Your Canine and other places.

Carole said her other club is raising their prices next year to \$130 for Puppy which is 10 weeks and \$150 for Beginners which is 12 weeks. They have always been cheaper than Glenbard.

Pat pointed out that our fees are in line with Lyons and Fox Valley. She said training facilities are higher because they are not all volunteers like dog clubs are. Carole said the instructors get paid.

Joan asked Gina to write up a proposal for a fee increase.

Joan mentioned she had gone to training at Francis field on Labor Day which was suppose to be 10 AM to 2 PM. It had started at 8 AM and the place was packed.

Our Obedience and Rally premium is out. Thursday is set up and then the Thursday fun match.

Lynn is going to wash the jumps for us.

Gina wanted to have the entry fees explained. All 6 trials, 3 Obedience and 3 Rally were a 1st entry of \$28. If you entered the same dog in anyone of the 6 twice then it would be \$22 for the second entry. Joan pointed out that some awards and or titles required you to enter the same dog two or three times (in different classes) at the same trial.

Karen mentioned doing something for Dick Schaefer at our trial. It is too late to put anything in the premium.

Joan will do signup sheet for volunteers for the trials.

New Mary asked if you had to be a member to volunteer. No, we welcome all volunteers.

Sandi asked about coffee for the trial. Candy takes care of that.

The food was excellent last year from the restaurant on the corner.

Pattie mentioned the Dianne Allen seminar the following week at Francis field.

Nominating Committee: Sandi reported that all the officers agreed to stay on. We have two board members up. One had not responded. The other was possibly. Gina volunteered for the board if one was needed. Sandi nominated Ed for the board.

Carole stated she felt officers and board members need to show up for both board and membership meetings, which combined are 12 a year. She said they should also be active with the club.

She said when she broke her arm she was out for 3 months. Since she is no longer showing Jake she is not taking advantage of the free training that comes along with her position on the board. She felt that maybe someone else might benefit more from the free training and also be more active with the club. If someone wanted her secretary position she would step down and her feelings would not be hurt.

Sandi will get a slate ready for October Barks. We will vote at the November meeting.

Meeting adjourned 8:17 PM. Ed made the motion.

Written 9-24-23 by Carole Moen, Glenbard secretary

Sent to members at the meeting 9-25-23 for review

Sent to Cheri for Barks 9-25-23





Jake goes to the Illinois Doberman Rescue Plus Gala, September 8th 2023 Our 20th Anniversary.

I was so excited that Jake got to come to our Gala. My broken arm had healed enough that I finally felt comfortable handling him again. I only had him inside for about an hour as he is old and gets tired easily.

There were three other black Dobes there. He was the only Red and the only old one. He's eleven. Bill and I had given Jake a bath and I did his ears prior to the event. Joan was kind enough to do Jake's nails for me. She uses a grinder which I was pleased about so they would not be sharp. Joan has done his nails for me several times since I broke my arm. Thank you Joan as I wanted Jake to look his best.

Jake was a big hit. I do feel having the Dobes present does help entice people to be generous with their spending. We had a silent and live auction. Bill took pictures for the event.

I also did a live interview that's on IDR+ Facebook page. I talked about having 10 Dobermans for 40 years and my last 8 have all been rescues. I added that they all had Obedience titles of some sort or another. I stated that my last two Jenna and Jake came to rescue at 8 years old. Jenna had 8 titles and Jake has 9. Both Jessie, the interviewer and I said "it goes to show you, you can teach an old dog new tricks".



Elsa tonight...making a new friend. (one of the lead lifeguard's sibes). If you look above else's ear, that might be a newf's ear. There was one there, swam a bunch. Probably had about 100 dogs. not as many as last year. Not as many in the pool...just sporting breeds, a couple of pits, the newf, and a border collie. But, it was pretty cool, too. Last year was much warmer. This was else's fifth time...7th year they have done it. It is so fun!



Thank you Laura P

On behalf of the nominating committee, We present the slate of officers for the upcoming year:

President Joan Mazat

Vice President

Membership Chair Karen Schlipf

Secretary Caroe Moen

Treasurer Shawn Hacker

Director of Training Pattin Imbrugia

BOD members

Only 2 positions expiring, Gerry Barra and Kathy Biancetti

Gerry agreed to stay on, but Kathy chose to vacate at this time. We thank her for her work and commitment to Glenbard.

The nomination for our new board member is Ed Gegenheimer

Respectfully submitted,

Sandi Stephenson
Nominating Committee Chair



Glenbard All Breed Obedience Club, Inc.

★★★ Salutes I

Thank you, Sandi S, for being such a good steward of Glenbard's history



Dorins Silk N Lace CD, CGC, TDI
Debbie Janik



Bonshire's Accolade CD
Sylvia Schultz



Castaway's Sweet Sassafras CD
Dawn Parison



Blumoon's Taz of Cascade
CDX, C-CDX
Lory LaPlant



Hillcrest Namten Restorer CDX, C-CDX,
CGC, TDI
Julie Damgaard



Ch Stahlkrieger Ebony Enchantor CDX
Jeanne Greenwalt



Lady Sassafras VIII CDX
Don Kloss



St. Andrew Triple Adventure CDX, JH,
WCX
Lee Melka



Apollo Von Rohda CDX
Sue Sutton



Misty Von Liebesgluck UD
Mary Russell



Otessa Vom Haus Kuhn UDX, C-CD,
HIC, CGC, TDI, BH
Lori Garncarz



Castaway's Magic Bulldozer UDX, WD,
WRD, DD
David Parison



Bearfoot's Jenna V. Eulenspiel UDX
Sandi Stephenson



FD Ch Smack-Dab's Odessa Texas
OA, CGC, TDI, WAC, Agll
Kathy Fay



FD Ch Comebye Wild West Wilma
Janine Jordan



FD Ch, U-ATCH, U-UD, A/C OTCH Brighteye
Bronco Bette UD, HCT, JHD, S-CD, BH, CGC



U-CD Jingles CD, Agll, CGC, TDI
Cathy Haake



Alaric Patent Pending TDX, CD, AC
Sylvia Schultz



Eliza Vom Steffen Haus CGC
Lori Garncarz

ts Stars Of 1994-1995 ★★



Ch T Sealair's Raggedy Ann UD, VST
Darlene Cerretto



U-ATCH, U-CDX Smack-Dab's Hidden
Treasure CGX, AX, S-CD, CGC, TDI, BH, TT
Kathy Fay

OBEDIENCE, WORKING and BREED TITLES EARNED IN 1994 - 1995

AKC - COMPANION DOG			STATES KENNEL CLUB - COMPANION DOG EXCELLENT		
Ray Gallup	Rott	Amberhaus Faust	Kathy Fay	Doberman	Salem
Connie Pace	Lab	My Boy Buster	AMBOR - COMPANION DOG		
Sandi Stephenson	Rott	Bearfoot's Jenna V. Eulenspiel	Marianne Guinee	Mix	Nena
Dawn Parison	Newfie	Castaway's Sweet Sassafras	UKC - AGILITY CHAMPIONS		
Kathy Krey	Golden Retriever	Lord Magnum Von Krey	Janine Jordan	Border Collie	Brighteye Bronco Bette
Janine Jordan	Border Collie	Brighteye Wild Blu Bingo	Kathy Fay	Doberman	Smack-Dab's Hidden Treasure
Cindy Wegner	Belgian Tervuren	Flasher	UKC-AGILITY I AND 11		
Kristin Cooper	Rott	Damien Von Der Hammer	Kathy Fay	Doberman	Salem
Karen Bouillion	Golden Retriever	Gold Bullion's Capture the Flag	Cathy Haake	Pug	Jingles
Debbie Janik	Collie	Dorins Silk N Lace	Kathy Fay	Doberman	Odessa
Donna Darland	Collie	Apollo	AKC AGILITY TITLES - NOVICE - OPEN - EXCELLENT		
William Clarke	Brittany Spaniel	Lady's Carmel Delight	Cindy Wegner	Belgian Tervuren	Curtains NA
Carol Moen	Doberman	Bikila's Outrageous of Marks-Tey	Kathy Fay	Doberman	Treasure OA/AX
Sue Sutton	German Shepherd	Apollo Von Rohda	Kathy Fay	Doberman	Odessa NA/OA
Cathy Haake	Pug	Jingles	HERDING CERTIFIED TESTED		
Kathy Fay	Doberman	Smack-Dab's Expose V. Dedo	Janine Jordan	Border Collie	Comebye Black Bart
Sylvia Schultz	Collie	Bonshire's Accolade	JUNIOR HERDING DOG		
AKC - COMPANION DOG EXCELLENT			Janine Jordan	Border Collie	Brighteye Bronco Bette
William Clarke	Brittany Spaniel	Lady's Carmel Delight	Janine Jordan	Border Collie	Comebye Maggie Mae
Sue Sutton	German Shepherd	Apollo Von Rohda	AKC - HERDING TESTED		
Walter Putirekis	Rott	Amber	Karen Zorn	Shetland Sheepdog	Rockcliff Blu Fog & Smoke
Julie Damgaard	English Springer Spaniel	Hillcrest Namten Restorer	Karen Zorn	Shetland Sheepdog	Rockcliff Blu Angel in Fog
Jeanne Greenwalt	Std. Schnauzer	Stahlkrieger Ebony Enchantor	Karen Zorn	Shetland Sheepdog	Driftwood Dancin' on Blu Water
Sandi Stephenson	Rott	Bearfoot's Jenna V. Eulenspiel	HUNTING, WATER AND WORKING TITLES		
Don Kloss	Doberman	Lady Sassafras VIII	Joyce Krueger	Flatcoat Retriever	Clarenjoy's Ombrey Rose WCX
Lee Melka	Golden Retriever	St. Andrew Triple Adventure	Lee Melka	Golden Retriever	St. Andrew Triple Adventure WCX
AKC - UTILITY DOG			David Parison	Vizsla	Vizion's Bounty Hunter JH
Mary Russell	German Shepherd	Misty Von Liebesgluck	Gwen Tomlinson	Vizsla	Nordic's Phantom Regiment JH
David Parison	Newfie	Castaway's Magic Bulldozer	Cheryl Peterson	Weim	Nordic's Good Golly Ms Molly JH
Sandi Stephenson	Rott	Bearfoot's Jenna V. Eulenspiel	Cheryl Peterson	Weim	Luckey JH
Lori Garncarz	German Shepherd	Otessa Vom Haus Kuhn	Julie Damgaard	English Springer Spaniel	Castaway's Magic Bulldozer WD, WRD, DD
AKC - TRACKING DOG			David Parison	Newfie	Nelson's Nordic Silver Streak NSD
Julie Sjulie	Vizsla	Vizzon's Blue Boy	Cheryl Peterson	Weim	Nordic's Good Golly Ms Molly NSD
Lori Garncarz	German Shepherd	Otessa Vom Haus Kuhn	Cheryl Peterson	Weim	Larado WAC
AKC - TRACKING DOG EXCELLENT			Merrylee Hritsuk	Doberman	Smack-Dab's Odessa Texas WAC
Sylvia Schultz	Collie	Alaric Patent Pending	Kathy Fay	Doberman	Expo WAC
AKC - CHAMPION TRACKER and VARIABLE SURFACE TRACKING			Kathy Fay	Doberman	Salem WAC
Darlene Cerretto	German Shepherd	Sealair's Raggedy Ann	NAFA - FLYBALL DOG CHAMPIONS		
AKC - BENCH CHAMPIONS			Janine Jordan	Border Collie	Comebye 'ell on Wheels
Gwen Tomlinson	Vizsla	Vizzon's Bounty Hunter	Janine Jordan	Border Collie	Brighteye Bronco Bette
Cindy Wegner	English Cocker	Spindrift's Captain Kidd	Janine Jordan	Border Collie	Comebye Wild West Wilma
Cheryl Peterson	Weim	Nordic's Phantom Regiment	Kathy Fay	Doberman	Smack-Dab's Hidden Treasure
Cheryl Peterson	Weim	Nordic's Good Golly Ms Molly	Kathy Fay	Doberman	Smack-Dab's Odessa Texas
Jeanne Greenwalt	Std. Schnauzer	Stahlkrieger Ebony Enchantor	Kathy Fay	Doberman	Indy
DOG WORLD AWARDS			Janine Jordan	Border Collie	Brighteye Wild Blu Bingo
David Parison	Newfie	Castaway's Magic Bulldozer	Janine Jordan	Border Collie	Comebye Maggie Mae
Sandi Stephenson	Rott	Bearfoot's Jenna V. Eulenspiel	Janine Jordan	Border Collie	Comebye Black Bart
Lori Garncarz	German Shepherd	Otessa Vom Haus Kuhn	TEMPERAMENT AND SCHUTZHUND TITLES		
CANADIAN KENNEL CLUB - COMPANION DOG			Kathy Fay	Doberman	Smack-Dab's Hidden Treasure BH, TT
Lori Garncarz	German Shepherd	Otessa Vom Haus Kuhn	Kathy Fay	Doberman	Smack-Dab's Odessa Texas TT
Julie Damgaard	English Springer Spaniel	Hillcrest Namten Restorer	Kathy Fay	Doberman	Smack-Dab's Expose V. Dedo TT
William Clarke	Brittany Spaniel	Lady's Carmel Delight	Merrylee Hritsuk	Doberman	Larado TT
CANADIAN KENNEL CLUB - COMPANION DOG EXCELLENT			Lori Garncarz	German Shepherd	Otessa Vom Haus Kuhn TT, BH
Gwynne Wright	Cairn Terrier	Glenmont Briarpatch	CANINE GOOD CITIZEN AND THERAPY DOGS		
Lory LaPlant	Schipperke	Blumoon's Taz of Cascade	Kathy Fay	Doberman	Smack-Dab's Hidden Treasure CGC, TDI
Julie Damgaard	English Springer Spaniel	Hillcrest Namten Restorer	Cheryl Peterson	Weim	Boo Peep CGC, TDI
UNITED KENNEL CLUB - COMPANION DOG			Debbie Janik	Collie	Dorins Silk N Lace CGC, TDI
Cathy Haake	Pug	Jingles	Carlo Moen	Doberman	Outrageous of Mark's-Tey CGC, TDI
Kathy Fay	Doberman	Indy	Kathy Fay	Doberman	Smack-Dab's Expose V. Dedo CGC, TDI
Kathy Fay	Doberman	Expo	Kathy Fay	Doberman	Smack-Dab's Odessa Texas CGC, TDI
Kathy Fay	Doberman	Salem	Arlene Andreoni	Golden Retriever	Breeze CGC, TDI
UNITED KENNEL CLUB - COMPANION DOG EXCELLENT			Janine Jordan	Border Collie	Brighteye Wild Blu Bingo CGC
Arlene Andreoni	Golden Retriever	Breeze	Janine Jordan	Border Collie	Comebye Maggie Mae CGC, TDI
Kathy Fay	Doberman	Salem	Cathy Haake	Pug	Jingles CGC, TDI
Kathy Fay	Doberman	Treasure	Tammy Dean	Rott	Roxie CGC
Kathy Fay	Doberman	Indy	Tammy Dean	Rott	Amber CGC
STATES KENNEL CLUB - COMPANION DOG			Laura Plasketes	Doberman	Pauper CGC, TDI
Kathy Krey	Golden Retriever	Lord Magnum Von Krey	Laura Plasketes	Doberman	Panache CGC, TDI
Kathy Fay	Doberman	Smack-Dab's Hidden Treasure	Laura Plasketes	Doberman	Teanest Nite'N Gale CGC, TDI
Kathy Fay	Doberman	Salem	Joyce Krueger	Flatcoat Retriever	Comebye Black Bart CGC
			Janine Jordan	Border Collie	Eliza Vom Steffen Haus CGC
			Lori Garncarz	German Shepherd	Hillcrest Namten Restorer CGC, TDI
			Julie Damgaard	English Springer Spaniel	Asland Cracklin' Kruegerand CGC, TDI
			Joyce Krueger	Golden Retriever	Gold Bullion's Capture the Flag TDI
			Karen Bouillion	Golden Retriever	Salem TDI
			Kathy Fay	Doberman	Indy TDI
			Kathy Fay	Doberman	



9 critical Pet Safety

THINGS TO REMEMBER AS SUMMER TURNS TO AUTUMN

1. Fleas and mites



Fleas can be a menace all year round and due to central heating will be attacking your dog even in the depths of winter! Consider treating the house with a suitable product. Ask your vet to recommend a good product – treatment will can provide cover for several months on end.

Tiny harvest mites are very difficult to see, but pay special attention to your pet's tummy, ears, eyes and paws during the autumn months. **Both fleas and mites can cause infections and other problems.**

2. Pesticides

Many people use household poisons to keep rodents and insects at bay. If your pet ingests one of these highly toxic products it could produce illness or even death. Beware,



in your own home or where you place these products and when walking your dog, be sure you watch him carefully.

3. Children's toys



children may leave their tiny toys and toxic craft material such as glue, magic markers etc. laying around so try to keep a close eye on this and try to get the children to tidy up after themselves!

If your pup chews and/or swallows one of these items he could experience an upset tummy or even more serious – a blockage.

4. Mushrooms and other outdoor hazards



aware of the growing threat of poisonous mushrooms during the autumn months. Should you spot your dog eating a mushroom and are unsure if it is poisonous or not, contact your vet immediately – better to be safe than sorry.

Conkers. Serious cases of poisoning are rare – ingestion can cause marked gastro-intestinal signs – drooling, retching, vomiting, diarrhoea and abdominal pain

5. Older pets

just like older humans, aging pets may have developed arthritic joints that make them more sensitive to the cold weather. Think about getting them a dog coat and check that your walks are not too long for them.



6. Kiddy in the car

Apparently, it's a pretty common thing and it only takes being mindful and beeping the horn a few times to potentially save a life. Don't want to wake the neighbours with a horn beep? Knocking a few times on the bonnet will also do the trick.



7. The anti-freeze

is very scary because it's too easy to make this mistake. You're in your garage with your dog, winterizing your car, you spill a little anti-freeze on the garage floor and mean to clean it up, but before you do, he has already taken a few licks because it smells sweet and good to him. It's very dangerous and can kill. Take the time to be extra careful with this toxic stuff



8. Whipping

Whipping out those special brushes that remove a dog's undercoat to reduce shedding? -- don't use them in winter. Your dog needs that undercoat during the colder weather to keep them warm.



9. ID tags

make sure your pets have current ID tags on them at ALL times.



www.finchleydogwalker.co.uk/

Obedience events #20232064007, #2023064008 & #2023064013
Rally events #2023064009, #2023064010 & #2023064012

PREMIUM LIST
Glenbard All Breed Obedience Club
Obedience and Rally Trials
Friday – Sunday, November 3– 5, 2023



(Licensed by The American Kennel Club)

Francis Field Youth Building - Indoors
801 E. Francis Road
New Lenox, IL 60451

Show Hours: Friday 8:00am to 5:00pm Central
Saturday & Sunday 7:00am to 5:00 pm Central
Remember there is a time change on Saturday Night.

Entries will be accepted in the order they are received.

Acceptance of entries will close on Wednesday, October 18, 2023 at
817 Ogden Ave. #4439
Lisle, IL 60532

or when judges' limits are reached if this occurs prior to the specified closing date,
after which entries cannot be accepted, cancelled or substituted.

**THIS EVENT IS OPEN TO MIX BREED DOGS THAT ARE ENROLLED
IN THE AKC CANINE PARTNERS PROGRAM**



Certification: Permission has been granted by the American
Kennel Club for holding this event under American Kennel Club
Rules and Regulations. Gina M. Dinardo, Executive
Secretary

OFFICERS

President.....Joan Mazat
Vice PresidentKaren Schlipf
TreasurerShawn Hacker
Secretary.....Carol Moen
.....23W450 Burdette Ave, Carol Stream, IL 60188-2144
Director of Training.....Pattie Imburgia

BOARD OF DIRECTORS

Candy Ellis, Gerry Bara, Cathy Bianchetti, Pat Senne, Sandi Stephenson

TRIAL COMMITTEE

Trial Chair.....Pat Senne
.....1N515 Center Ave, West Chicago, IL
.....Psenne52@hotmail.com 630-215-3976
Trial Co-ChairJoan Mazat
Match ChairJoan Mazat
Chief Ring StewardLiz Hixon
Hospitality.....Candy Ellis
Awards & Ribbons.....Pat Senne

TRIAL SECRETARY

Robert Olson
817 Ogden Ave. #4439, Lisle, IL 60532
(815) 242-5483
Email - secretary@livetrial.net

VETERINARIAN (on call)

Animal Emergency of Mokena
19110 S. 88th Avenue, Mokena, IL 60448
708-326-4800

CLASSES OFFERED

Obedience - Regular Classes

Novice A, Novice B, Open A, Open B, Utility A, Utility B, UDX

Obedience - Preferred Classes

Preferred Novice, Preferred Open, Preferred Utility, Preferred UDX

Obedience - Optional Titling Classes

Beginner Novice A, Beginner Novice B,
Graduate Novice, Graduate Open, Versatility

Rally - Regular Classes

Novice A, Novice B, Intermediate, Advanced A, Advanced B,
Excellent A, Excellent B, Master, Choice, RAE, RACH
Rally Ring Size: 40' x 50'

Obedience and Rally entries must include dog's jump height if applicable

SIGN UP

JUDGES

EACH JUDGE WILL BE LIMITED TO 8 HOURS JUDGING

Ms. Cynthia A Rustad #7509 4205 Evergreen Ln N, Plymouth, MN 55441
Mr. Philip D Rustad #7067 4205 Evergreen Ln N, Plymouth, MN 55441

OBEDIENCE ASSIGNMENTS

Saturday, Event # 2023064007: Philip Rustad
Saturday, Event # 2023064013: Cynthia Rustad
Sunday, Event # 2023064008: Cynthia Rustad

RALLY ASSIGNMENTS

Friday, Event # 2023064009: Philip Rustad
Friday, Event # 2023064010: Cynthia Rustad
Sunday, Event # 2023064012: Philip Rustad

The Friday Rally trials will be running concurrently, so move ups from one trial to the other will not be allowed.

Transfers: Transfers after the closing date will be accepted at these trials.

Jump Height Order: Obedience classes with jumps will be run small to tall both days starting with 4". Every effort will be made to accommodate handlers with multiple dogs in the same class.

COVID-19 rules are subject to the State of Illinois mandates at the time of trial and AKC best practices are in effect.



ENTRY FEES

Obedience: \$28.00 for the first entry of a dog.
\$22.00 for each additional entry of the same dog, per day.
Rally: \$28.00 for the first entry of a dog.
\$22.00 for each additional entry of the same dog, per day.

Dogs entered in both Obedience and Rally require a First Entry fee for each Rally event and each Obedience event.

Make checks payable to GABOC. Mail entries with fees to Robert Olson, 817 Ogden Ave. #4439, Lisle, IL 60532. Entries mailed overnight must waive recipient signature, or they will be returned. Entries will not be accepted without fees. Returned checks do not constitute valid entry fees and are subject to an additional service charge. All entries must be on a signed AKC form with the AKC agreement on back. Entries on an invalid form will be returned.

Hand Delivery address: 22W462 Sycamore Dr, Glen Ellyn, IL 60137. Place entries in the dropbox next to the front door. (The Lisle address is the Post Office).

The Glenbard All Breed Obedience Club and their Trial Secretary assume no responsibility for an incorrect entry. Exhibitors are advised to print or type all unusual words when filling in entry forms. No dog wrongly entered in a class may be transferred to another class after the closing date, except as provided for in Chapter 11, Section 6 of the AKC rules and Regulations. No entry may be cancelled unless notice of the change or cancellation is received in writing by the trial secretary named in the premium list to receive entries, prior to the closing date and hour for entries, except that a correction may be made in the sex of the dog. Owners are responsible for errors in the entry form, regardless of who may make such error. It is strongly suggested that entrants provide an email address so that a notification of entry may be sent and allow for entrants to review their entry information for errors.

Pursuant to Chapter 1, Section 3, entries will not be accepted unless submitted with the required entry fee, be on an official American Kennel Club entry form, be signed by the owner or his duly authorized agent and must have the required information - name of trial giving club, date of trial, breed, sex, name of class(es) entered, full/registered name of dog, name of owner(s)/ co-owner(s), address of owner, one of the following - AKC registration number or PAL/ILP number, if known the following - date of birth, place of birth, name of breeder(s), name of sire and dam. Entries must be submitted on approved entry forms with the agreement printed on the reverse side.

Move ups in Obedience and Rally will be accepted provided the next level class and judge are available and the class has not reached its limit. The request for a move up must be made in writing and presented to the trial secretary at least 30 minutes prior to the start of the trial. Move ups from one Rally trial to the other on Friday will not be allowed.

Entries will not be refunded in the event a dog is absent, disqualified, excused by a veterinarian or judge, barred from competition by action of the trial committee or, if because of riots, civil disturbances or other acts beyond the control of the management, it is impossible to open or complete this trial.

Refunds of \$3.00 or less will not be issued due to the cost of processing. Entry fees will not be refunded after the closing date or when classes close, whichever comes first.

Bitches in season are not permitted to compete. If a bitch is withdrawn from competition because it came into season and the event secretary is notified no later than one half hour prior to the start of the first class in the trial, the club will refund the entry fee.



Sign Up Now

AWARDS

All awards must be claimed at the show, none will be mailed.

RALLY AWARDS

Highest Combined Score in Advanced B and Excellent B..... Blue & Green Rosette
Highest Combined Triple Qualifying (HTQ) score in
Advanced B, Excellent B and Master..... Blue & Red Rosette
First Prize Blue Ribbon
Second Prize Red Ribbon
Third Prize Yellow Ribbon
Fourth Prize White Ribbon
Qualifying Score Green Ribbon
New Title Purple Rosette
RACH Deluxe Rosette

Rally Cash Awards

Highest Combined Score in Advanced B and Excellent B..... \$25.00
Highest Combined Triple Qualifying (HTQ) score in
Advanced B, Excellent B and Master..... \$25.00

OBEDIENCE AWARDS

Highest Scoring Dog in Regular Classes..... Blue & Gold Rosette
Highest Combined Score in Open B and Utility..... Blue & Green Rosette
First Prize Blue Ribbon
Second Prize Red Ribbon
Third Prize Yellow Ribbon
Fourth Prize White Ribbon
Qualifying Score Green Ribbon
New Title Purple Rosette
OTCH Deluxe Rosette

Obedience Cash Awards

Highest Scoring Dog In Regular Classes \$50.00
Highest Combined Score in Open B and Utility \$50.00

No dogs except those properly entered at this trial will be allowed within the trial precincts.

Dogs are not required to be at the trial until the scheduled time of judging, and may leave immediately thereafter unless required for further judging. The owner/handler is solely responsible for having the dog ready at ringside when the class is to be judged. Conflicts between rings should be discussed with the judge prior to the start of the class.

There will be a limited number of catalogs available for sale at the trial. If you would like a catalog, please pre-order a catalog by checking the box on the entry form, include \$5.00 with your entry fees, and one will be reserved for you.

The show giving club, the Trial Secretary, their agents, etc. Assume no responsibility for any loss, damage or injury sustained by the exhibitors, handlers or to any of their dogs or property, and assume no responsibility for injury to children, who must be under the control of their parents or guardians.

Please be respectful to others and turn cell phones off or put them on vibrate. No use of a flash is permitted if taking photos during the judging of any dog.

Exhibitors are asked to please bring your own chairs,

Exhibitors and spectators are expected to keep the show grounds clean. Please pick up after your dogs. Exhibitors should follow their veterinarians' recommendation to assure their dogs are free of internal and external parasites, any communicable diseases, and have appropriate vaccinations.

HOTELS ACCEPTING DOGS (please confirm pet policy when making reservations):

Following are hotels that accept well-mannered, housebroken dogs. Managers request that grooming be restricted to show grounds. Owners are responsible for cleaning up after their dogs.

LaQuinta Inn & Suites Chicago Tinley Park

7255 W. 183rd, Tinley Park, IL 60477 708-633-1200

Motel Super 8 Mokena / Frankfort / I-80

9485 W. 191st St, I-80 at Exit 145A, Mokena IL 60448-8308
708-479-7808

**Please notify the motel of your choice
that you have pets!**

Boxed lunches will be provided to judges and workers.

No kitchen services will be available.

Exhibitors can purchase food at several of the local restaurants.

Please visit our website at www.gaboc.org



Glenbard All Breed Obedience Club November 3 – 5, 2023



Entry fees \$28 for first entry per dog per trial,
\$22 each additional entry per dog per trial

- Friday, Nov 3 Rally 1 (#2023064009) Rally 2 (#2023064010)
 Saturday, Nov 4 Obedience 1 (#2023064007) Obedience 2 (#2023064013)
 Sunday, Nov 5 Obedience 3 (#2023064008) Rally 3 (#2023064012)
 Catalog (\$5)

Entries close Weds, Oct 18, 2023 I have enclosed \$_____ for entry fees

IMPORTANT Read *Instructions* on reverse side carefully before filling out. Numbers in the boxes indicate sections of the instructions relevant to the information needed in that box (PLEASE PRINT). Next, be sure to read the Agreement and sign on the reverse. **No form will be processed without your signature!**

Breed*	Variety ¹	Sex
Obedience Class(es) (please circle) ^{2,3} NOV A NOV B OPN A OPN B UTIL A UTIL B PREF NOV PREF OPN PREF UTIL		Jump Height
Rally Class (please circle) NOV A NOV B INTERM ADV A ADV B		Jump Height
Name of Junior Handler (if Any)		Junior Handler Number
Full Name of Dog		

<input type="checkbox"/> AKC No. ⁴ Enter number here	<input type="checkbox"/> Foreign Reg No	Place of Birth (Enter country below) <i>Do not print the country in catalog</i>	Date of Birth
--	---	--	---------------

Breeder

Sire

Dam

Actual Owner(s)
(Please Print)

Owner's Address

City	State/Prov	Zip/Postal Code	Country (if not USA)
------	------------	-----------------	----------------------

Telephone #	Are you a new exhibitor? <input type="checkbox"/> Yes <input type="checkbox"/> No
-------------	---

Email Address (an acknowledgement or receipt of entry may be sent to this email address)

Name of Agent/Handler at the Show (if any)

*** Be sure to read the Agreement and sign on the reverse. No form will be processed without your signature! ***

INSTRUCTIONS

- (Variety) if you are entering a dog of breed in which there are varieties for show purposes, please designate the particular variety you are entering, i.e., Cocker Spaniel (solid color black, ASCOB, parti-color), Beagles (not exceeding 13 in., over 13 in. but not exceeding 15 in.), Dachshunds (longhaired, smooth, wirehaired), Collies (rough, smooth), Bull Terriers (colored, white), Manchester Terriers (standard, toy), Chihuahuas (smooth coat, long coat), English Toy Spaniels (King Charles and Ruby, Blenheim and Prince Charles), Poodles (toy, miniature, standard).
- (Event Class) Consult the classification in this premium list. If the event class in which you are entering your dog is divided, then, in addition to designating the class, specify the particular division of the class in which you are entering your dog, i.e. A or B division.
- A dog must be entered in the name of the person who actually owned it at the time entries for an event closed. If a registered dog has been acquired by a new owner it must be entered in the name of its new owner in any event for which entries closed after the date of acquirement, regardless of whether the new owner has received the registration certificate indicating that the dog is recorded in his/her name. State on entry form whether transfer application has been mailed to the AKC. (For complete rules, refer to Chapter 11, Section 3.)
- Dogs listed in the **AKC Canine PartnersSM** Program may be eligible to enter all-breed AKC Obedience trials at the club's option. These dogs should be listed as All American Dog and must include their AKC Number on the entry form and check the AKC No. box. Sire and Dam information shall remain blank for mixed breed entrants.

AKC Rules, Regulations, Policies and Guidelines are available on the American Kennel Club website: www.akc.org

AGREEMENT

I certify that I am the actual owner of the dog, or that I am the duly authorized agent of the actual owner whose name I have entered above. In consideration of the acceptance of this entry, I (we) agree to abide by the rules and regulations of The American Kennel Club in effect at the time of this event, and any additional rules and regulations appearing in the premium list of this event and entry form and any decision made in accord with them. I (we) agree that the club holding this event has the right to refuse this entry for cause which the club shall deem sufficient. I (we) certify and represent that the dog entered is not a hazard to persons or other dogs. In consideration of the acceptance of this entry and of the holding of this event and of the opportunity to have the dog judged and to win prizes, ribbons, or trophies, I (we) agree to hold the AKC, the event-giving club, their members, directors, governors, officers, agents, superintendents or event secretary and the owner and/or lessor of the premises and any provider of services that are necessary to hold this event and any employees or volunteers of the aforementioned parties, and any AKC approved judge, judging at this event, harmless from any claim for loss or injury which may be alleged to have been caused directly or indirectly to any person or thing by the act of this dog while in or about the event premises or grounds or near any entrance thereto, and I (we) personally assume all responsibility and liability for any such claim; and I (we) further agree to hold the aforementioned parties harmless from any claim for loss, injury or damage to this dog. Additionally, I (we) hereby assume the sole responsibility for and agree to indemnify, defend and save the aforementioned parties harmless from any and all loss and expense (including legal fees) by reason of the liability imposed by law upon any of the aforementioned parties for damage because of bodily injuries, including death at any time resulting therefrom, sustained by any person or persons, including myself (ourselves), or on account of damage to property, arising out of or in consequence of my (our) participation in this event, however such, injuries, death or property damage may be caused, and whether or not the same may have been caused or may be alleged to have been caused by the negligence of the aforementioned parties or any of their employees, agents, or any other person. I (WE) AGREE THAT ANY CAUSE OF ACTION, CONTROVERSY OR CLAIM ARISING OUT OF OR RELATED TO THE ENTRY, EXHIBITION OR ATTENDANCE AT THE EVENT BETWEEN THE AKC AND THE EVENT-GIVING CLUB (UNLESS OTHERWISE STATED IN THIS PREMIUM LIST) AND MYSELF (OURSELVES) OR AS TO THE CONSTRUCTION, INTERPRETATION AND EFFECT OF THIS AGREEMENT SHALL BE SETTLED BY ARBITRATION PURSUANT TO THE APPLICABLE RULES OF THE AMERICAN ARBITRATION ASSOCIATION. HOWEVER, PRIOR TO ARBITRATION ALL APPLICABLE AKC BYLAWS, RULES, REGULATIONS AND PROCEDURES MUST FIRST BE FOLLOWED AS SET FORTH IN THE AKC CHARTER AND BYLAWS, RULES, REGULATIONS, PUBLISHED POLICIES AND GUIDELINES.

■ Signature of owner or his agent
duly authorized to make this entry:

Telephone	Email
-----------	-------

AO9999 (01/17) v1.0(RD)

Be There.

Glenbard All Breed Obedience Club November 3 – 5, 2023



Entry fees \$28 for first entry per dog per trial,
\$22 each additional entry per dog per trial

Friday, Nov 3 Rally 1 (#2023064009) Rally 2 (#2023064010)
 Saturday, Nov 4 Obedience 1 (#2023064007) Obedience 2 (#2023064013)
 Sunday, Nov 5 Obedience 3 (#2023064008) Rally 3 (#2023064012)
 Catalog (\$5) I have enclosed \$_____ for entry fees

Entries close Weds, Oct 18, 2023

IMPORTANT Read instructions on reverse side carefully before filling out. Numbers in the boxes indicate sections of the instructions relevant to the information needed in that box. (PLEASE PRINT). Next, be sure to read the Agreement and sign on the reverse.

No form will be processed without your signature!

Breed ¹	Variety ¹	Sex
Obedience Class(es) (please circle) ^{2,3} NOV A NOV B OPN A OPN B UTIL A UTIL B PREF NOV PREF OPN PREF UTIL		Jump Height
GRAD NOV GRAD OPN BEG NOV A BEG NOV B VER		
Rally Class (please circle) NOV A NOV B INTERM ADV A ADV B		Jump Height
EXC A EXC B MASTER CHOICE		
Name of Junior Handler (If Any)		Junior Handler Number
Full Name of Dog		

<input type="checkbox"/> AKC No. ⁴ Enter number here	<input type="checkbox"/> Foreign Reg No	Place of Birth (Enter country below) <i>Do not print the country in catalog</i>	Date of Birth
Breeder			
Sire			
Dam			
Actual Owner(s) (Please Print)			
Owner's Address			
City	State/Prov	Zip/Postal Code	Country (if not USA)
Telephone #	Are you a new exhibitor? <input type="checkbox"/> Yes <input type="checkbox"/> No		
Email Address (an acknowledgement or receipt of entry may be sent to this email address)			
Name of Agent/Handler at the Show (if any)			

*** Be sure to read the Agreement and sign on the reverse. No form will be processed without your signature! ***

INSTRUCTIONS

- (Variety) if you are entering a dog of breed in which there are varieties for show purposes, please designate the particular variety you are entering, i.e., Cocker Spaniel (solid color black, ASCOB, parti-color), Beagles (not exceeding 13 in., over 13 in. but not exceeding 15 in.), Dachshunds (longhaired, smooth, wirehaired), Collies (rough, smooth), Bull Terriers (colored, white), Manchester Terriers (standard, toy), Chihuahuas (smooth coat, long coat), English Toy Spaniels (King Charles and Ruby, Blenheim and Prince Charles), Poodles (toy, miniature, standard).
- (Event Class) Consult the classification in this premium list. If the event class in which you are entering your dog is divided, then, in addition to designating the class, specify the particular division of the class in which you are entering your dog, i.e. A or B division.
- A dog must be entered in the name of the person who actually owned it at the time entries for an event closed. If a registered dog has been acquired by a new owner it must be entered in the name of its new owner in any event for which entries closed after the date of acquirement, regardless of whether the new owner has received the registration certificate indicating that the dog is recorded in his/her name. State on entry form whether transfer application has been mailed to the AKC. (For complete rules, refer to Chapter 11, Section 3.)
- Dogs listed in the **AKC Canine PartnersSM** Program may be eligible to enter all-breed AKC Obedience trials at the club's option. These dogs should be listed as All American Dog and must include their AKC Number on the entry form and check the AKC No. box. Sire and Dam information shall remain blank for mixed breed entrants.

AKC Rules, Regulations, Policies and Guidelines are available on the American Kennel Club website: www.akc.org

AGREEMENT

I certify that I am the actual owner of the dog, or that I am the duly authorized agent of the actual owner whose name I have entered above. In consideration of the acceptance of this entry, I (we) agree to abide by the rules and regulations of The American Kennel Club in effect at the time of this event, and any additional rules and regulations appearing in the premium list of this event and entry form and any decision made in accord with them. I (we) agree that the club holding this event has the right to refuse this entry for cause which the club shall deem sufficient. I (we) certify and represent that the dog entered is not a hazard to persons or other dogs. In consideration of the acceptance of this entry and of the holding of this event and of the opportunity to have the dog judged and to win prizes, ribbons, or trophies, I (we) agree to hold the AKC, the event-giving club, their members, directors, governors, officers, agents, superintendents or event secretary and the owner and/or lessor of the premises and any provider of services that are necessary to hold this event and any employees or volunteers of the aforementioned parties, and any AKC approved judge, judging at this event, harmless from any claim for loss or injury which may be alleged to have been caused directly or indirectly to any person or thing by the act of this dog while in or about the event premises or grounds or near any entrance thereto, and I (we) personally assume all responsibility and liability for any such claim; and I (we) further agree to hold the aforementioned parties harmless from any claim for loss, injury or damage to this dog. Additionally, I (we) hereby assume the sole responsibility for and agree to indemnify, defend and save the aforementioned parties harmless from any and all loss and expense (including legal fees) by reason of the liability imposed by law upon any of the aforementioned parties for damage because of bodily injuries, including death at any time resulting therefrom, sustained by any person or persons, including myself (ourselves), or on account of damage to property, arising out of or in consequence of my (our) participation in this event, however such, injuries, death or property damage may be caused, and whether or not the same may have been caused or may be alleged to have been caused by the negligence of the aforementioned parties or any of their employees, agents, or any other person. I (WE) AGREE THAT ANY CAUSE OF ACTION, CONTROVERSY OR CLAIM ARISING OUT OF OR RELATED TO THE ENTRY, EXHIBITION OR ATTENDANCE AT THE EVENT BETWEEN THE AKC AND THE EVENT-GIVING CLUB (UNLESS OTHERWISE STATED IN THIS PREMIUM LIST) AND MYSELF (OURSELVES) OR AS TO THE CONSTRUCTION, INTERPRETATION AND EFFECT OF THIS AGREEMENT SHALL BE SETTLED BY ARBITRATION PURSUANT TO THE APPLICABLE RULES OF THE AMERICAN ARBITRATION ASSOCIATION. HOWEVER, PRIOR TO ARBITRATION ALL APPLICABLE AKC BYLAWS, RULES, REGULATIONS AND PROCEDURES MUST FIRST BE FOLLOWED AS SET FORTH IN THE AKC CHARTER AND BYLAWS, RULES, REGULATIONS, PUBLISHED POLICIES AND GUIDELINES.

■ Signature of owner or his agent
duly authorized to make this entry:

Telephone	Email
-----------	-------

AO9999 (01/17) v1.0(RD0)



Come to the GABOC Pre-Trial Fun Matches!

RALLY: THURSDAY November 2, 2023

At Francis Field

4:30 p.m. – 7:00 p.m.

Price includes two runs.

\$8.00 for the first dog, \$6.00 for each additional dog

OBEDIENCE: FRIDAY November 3, 2023

At Francis Field

4:00 p.m. – 7:00 p.m.

\$8.00 for the first entry,

\$6.00 for the second entry of the same dog

Start time 4:00 p.m.

Classes offered Novice, Open, Utility,
Beginner Novice, Graduate Novice, Graduate Open

Registration opens October 7, 2023

Register and pay online at

<https://www.gaboc.org/fun-matches>

See you there!!!

**Contact Joan Mazat at GabocPresident@gmail.com
with any questions**

Francis Field is located 801 E. Francis Road in New Lenox, IL. There will be no charge for parking.

At the Francis Field site we have limited RV hookups available. Please contact Pat Senne at psenne52@hotmail.com if you are considering bringing an RV.

DIRECTIONS TO TRIAL SITE

From I-80

Exit Route 30 (Maple Street) East. To Cedar Road stop light turn Left. To Francis Road turn Right. The 4H field will be on your left.

From I-355

Exit on Route 6. Go East on Route 6, to Cedar stoplight turn Right. To Francis Road turn Left. The 4H field will be on your left.

From Route 50 or 45. Go to Laraway Road or Route 30. Turn West to SchoolHouse Road, turn Right. (just West of Wolf Road - Stop Sign if coming off of Laraway, Stop Light if coming off of Route 30; Deadend on Francis Road - turn Left. The 4H field will be on your right about a mile down.

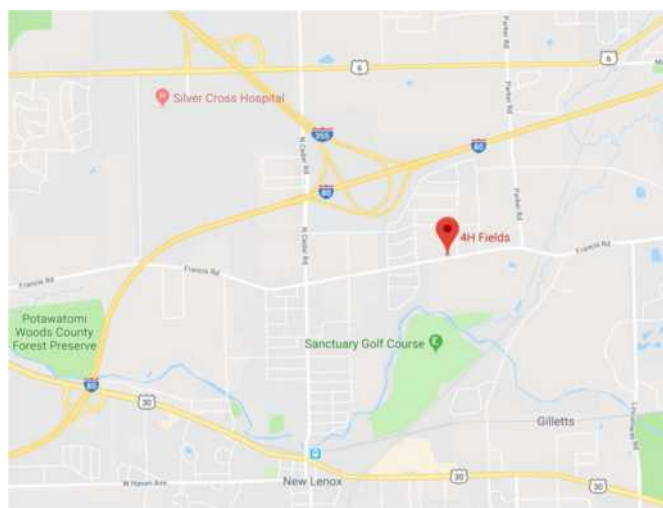

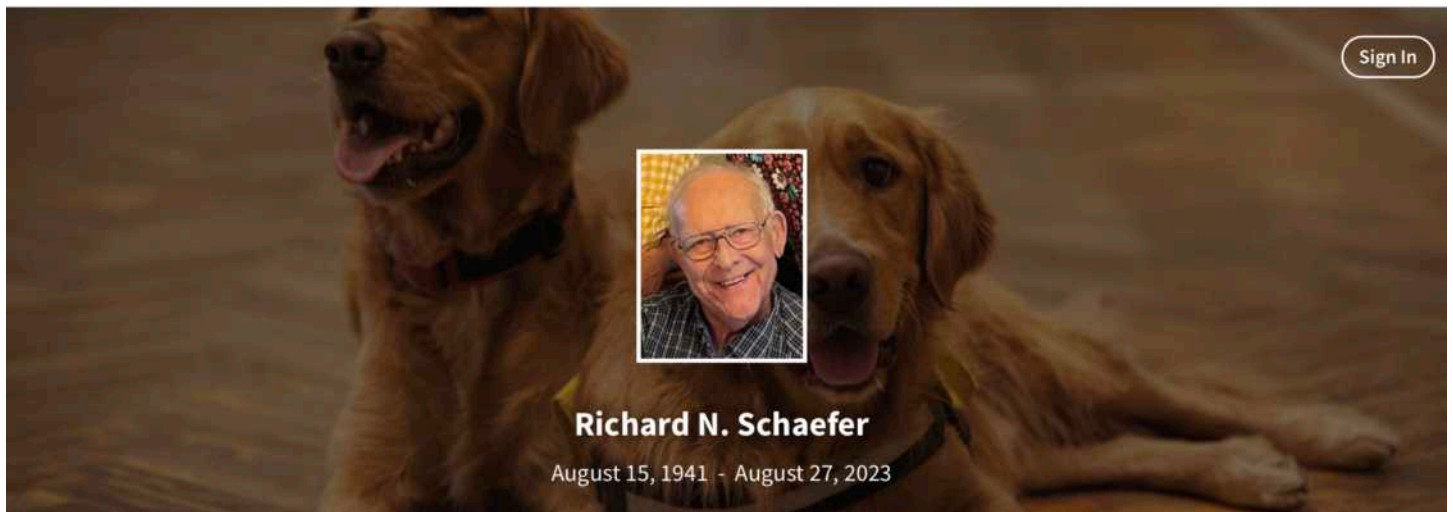

Richard N. Schaefer

Age 82 of New Lenox, IL passed away peacefully in his home on Sunday, August 27, 2023. Richard was born in Chicago, IL to the late Nicholas and Mildred (nee Bater) Schaefer. Husband of the late Dolores (nee Churas); loving father of Debbie (Richard) Frazier and Mike (Tricia) Schaefer; cherished grandfather of Emily and Seth Schaefer; dear brother of the late Patricia (Gerald) Turrise, uncle, and beloved friend of many. Richard was a proud member of IUOE Local 150, and he retired from the Metropolitan Water Reclamation District of Greater Chicago. He loved Golden Retrievers and German Shepards, and was an award-winning dog obedience trainer, having achieved the distinction of training multiple OTCH dogs. He was an avid outdoorsman in his younger days and enjoyed hunting and fishing with friends and family. He also enjoyed travel, having reached his lifelong goal of visiting Germany for Oktoberfest with his family. The final years of his life were capped with many cherished dinner outings with his dear friends. The family will receive friends at Kurtz Memorial Chapel 102 E. Francis Rd. New Lenox, IL on Tuesday, September 5, 2023, for a Memorial visitation from 10:00am – 1:00pm.

Remembering Our Friend...



2022 TITLE HOLDERS



Kian

RACH3 Riverside Rhyme and Reason CDX PCDX
BN GN **RM8 RAE8**
Earned in 2022: **RM7, RM8, RAE7, RAE8**
Owned, Trained/Handled & Loved by
Cathy Haake



Indigo

Kimber Vom Haus Miller Indigo **CD CGC**
EARNED 2022: **CD**
Owned, Trained/Handled & Loved by
Pattie Imburgia



Rosie

Fraulein Sergeant Rose of Glenwood II **CGC RI BN CD TKN**
Earned in 2022: **TKN**
Owned, Trained/Handled & Loved by
Marytherese Marosits



Sarge

Herr Sergeant of Glenwood V **RN CGC RI BN**
Earned in 2022: **RN CGC RI BN**
Owned, Trained/Handled & Loved by
Marytherese Marosits



Mars
Mondenkind's Majestic Phaze UD CDX RE CGC
TKN S.T.A.R. Puppy
Earned in 2022: RE
Owned, Trained/Handled & Loved by
Joan Mazat



Windy
Esmonds Bel Air Rides Like the Wind UD PUTD PUDX RE CGC
Earned in 2022: PUDX
Owned, Trained/Handled & Loved by
Joan Mazat



Chip
Goodwin Dealer's Choice CD RN BN
EARNED 2022: CD RN BN
Owned, Trained/Handled & Loved by
Bette McMillan



Jake
Jake A New Beginning BN RN RI CGC CGCA TKN
VHMA
Earned in 2022: RI
Owned, Trained/Handled & Loved by
Carole Moen

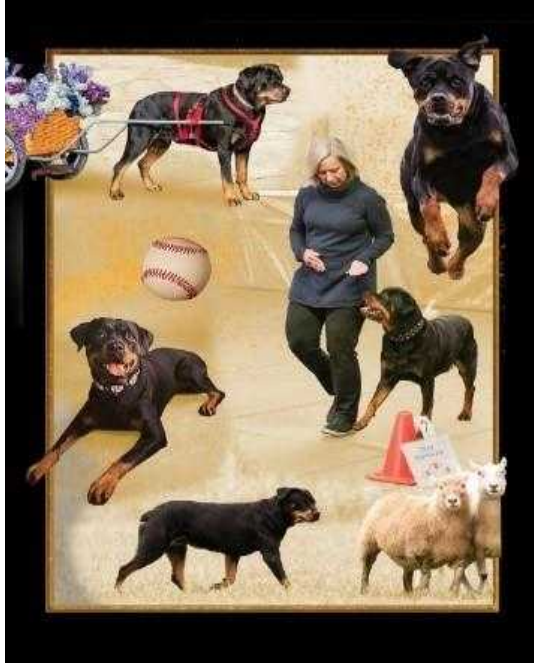

Gabby

RACH Player's Girl Just Wants To Have Fun VCD2 BN
 RM2 RAE2 TD PT FDC MXP MJP BCAT TT CS CI **THDX**
 OSD CGCA CGCU TKP ATT
 EARNED 2022: **THDA THDX**
 Owned, Trained/Handled & Loved by
Carol Schmidt



Gracie

Lando N' Rockets Footloose N' Fancy Free@Senne
CD BN RE BCAT DCAT TKI CGCA
 Earned in 2022: **CD RE BCAT DCAT**
 Owned, Trained/Handled & Loved by
Pat Senne



Smokey

Prairie Hill's It's All About the Smoke CD BN TKN
RAE NA NAJ OA OAJ CGC SCN
 Earned in 2022: **RAE SCN**
 Owned, Trained/Handled & Loved by
Pat Senne



Secret

CH Haznow's Victoria's Secret UD RA OM1 RN
RA OM1
 Earned in 2022: **RN RA OM1**
 Owned, Trained/Handled & Loved by
Sandi Stephenson

I PICKED MY PUMPKIN...



DID YOU?